

V-40~47

PRECISION RAPID VICE

Model: HG-100,150(A,B,C,D),
HG-175(B,C,D), 200(A,B,C)

- Designed with an instant clamping Hex-Nut for quick adjustment when clamping different work-pieces with irregular lengths.
- Movable Jaw can be easily moved for clamping etc.
- Jaws are slotted for increased grip on workpiece.
- Movable Jaw is short in length for maximum opening capacity.
- Tapered Jaws provide more stable clamping.
- Made entirely of steel the Vice is strong and powerful and retains accuracy.
- Compact design allows maximum workholding capacity on machine.

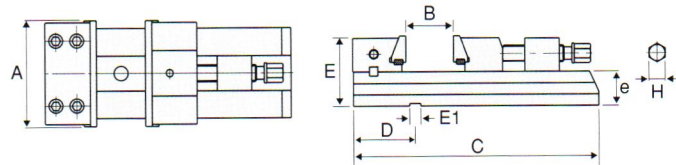

STANDARD ACCESSORIES:

- 2 pcs of Alignment Wedge
- 4 pcs of Clamp

SPECIFICATIONS (Material: S50C. Hardness: HRC 52°~56°)

Unit: mm

NO	Model	A	B	C	D	E	E1	e	H	Clamping force	Weight (kg)
V-40	HG-100	100	100	250	73 ± 0.02	68	14	37 ± 0.01	12	2000kg	8
V-41	HG-150A	150	150	350	85 ± 0.02	95	18	48 ± 0.01	19	3000kg	23
V-42	HG-150B		200	400							25
V-43	HG-150C		250	450							27
V-44	HG-150D		300	500							29
V-42A	HG-175B	175	200	450	85 ± 0.02	119	18	62 ± 0.01	19	5000kg	42
V-43A	HG-175C		250	500							46
V-44A	HG-175D		300	550							51
V-45	HG-200A	205	200	470	85 ± 0.02	126	18	63 ± 0.01	19	5000kg	55
V-46	HG-200B		250	520							63
V-47	HG-200C		300	570							73

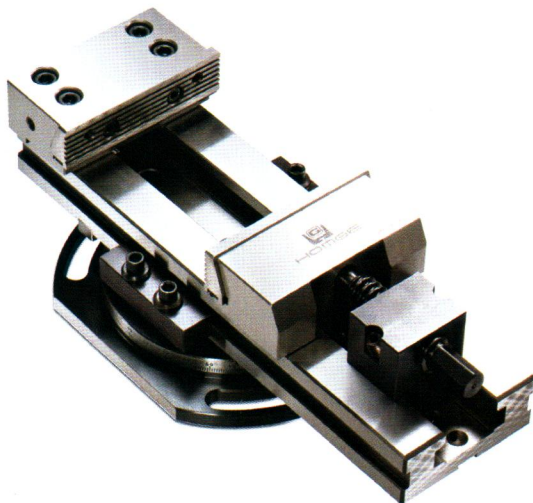

V-48~54

PRECISION RAPID VICE WITH SWIVEL BASE

Model: HG-150S(A,B,C,D), 200S(A,B,C)

STANDARD ACCESSORIES:

- 2 pcs of Alignment Wedge
- 4 pcs of Clamp

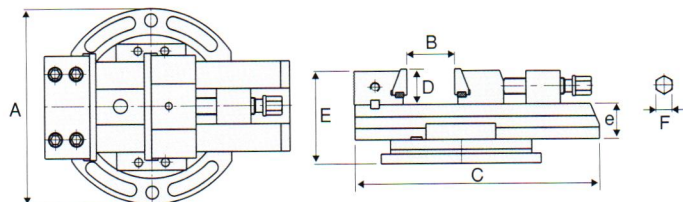

SPECIFICATIONS (Material: S50C. Hardness: HRC 52°~56°)

Unit: mm

NO	Model	A	B	C	D	E	e	F	Clamping force	Weight (kg)
V-48	HG-150SA	275	150	350	50	128	48 ± 0.01	19	3000kg	33
V-49	HG-150SB		200	400						35
V-50	HG-150SC		250	450						37
V-51	HG-150SD		300	500						39
V-52	HG-200SA	350	200	470	69	163	63 ± 0.01	19	5000kg	65
V-53	HG-200SB		250	520						73
V-54	HG-200SC		300	570						83